

Instructions of use for ObiPen

A. Making injection

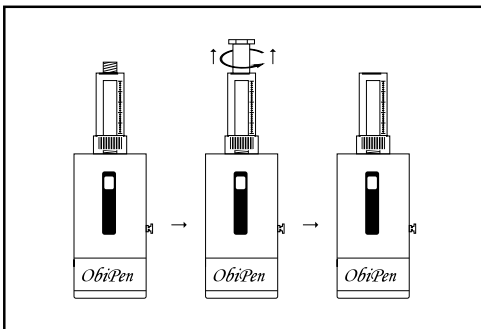

1) Using the needle connector handler, unscrew the needle connector.

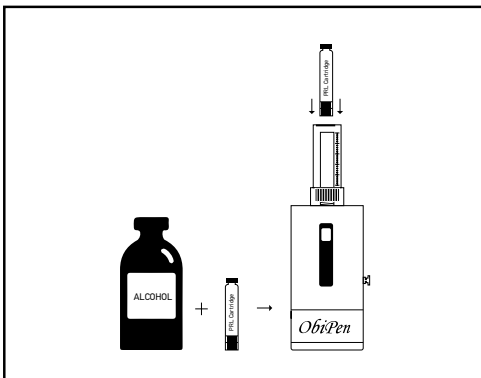

2) Wipe the cap of the PRL cartridge with alcohol and insert it into the cartridge compartment.

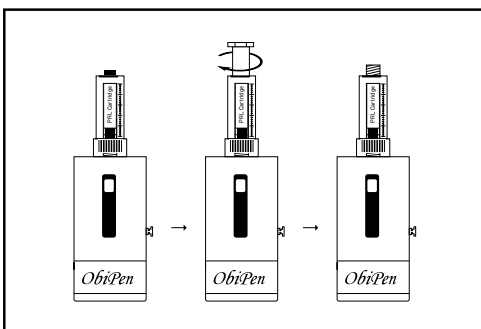

3) Again using the needle connector handler, screw the needle connector to its original place.

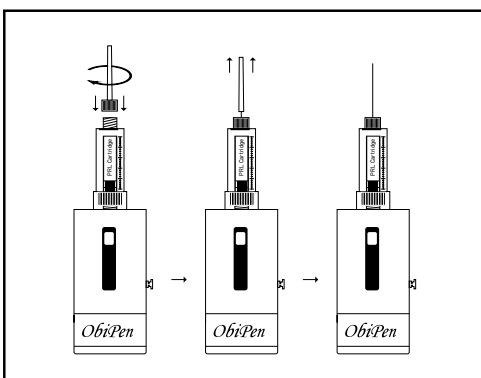

4) Screw the needle on the needle connector and take off the outer protection cover of the needle (it has two protection covers).

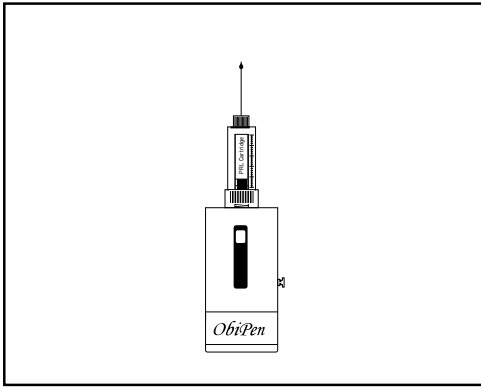

- 5) To take off any bubbles of air that may exist inside the PRL cartridge:
- Ensure that the dose regulator is in its lower position.
 - Keep ObiPen vertically, with the needle looking up.
 - Take off the inner protection cover of the needle.
 - Press the start-stop button two times (on and off) very quickly.
 - Unscrew the dose regulator and watch one or two drops getting out of the tip of the needle.
 - If no drop gets out, repeat steps d to f.

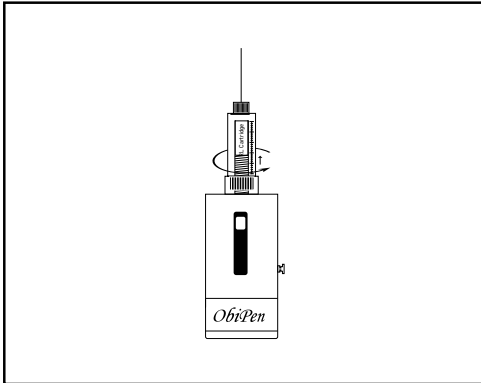

- 6) Regulate the dose using the dose regulator. To do so, screw or unscrew the dose regulator until it reaches the desired point on the dose scale. If, for example, you want to regulate the dose to 1.2 ml, you must bring the upper side of the dose regulator exactly to the 1.2 ml mark of the dose scale.

7) Wipe the skin on the site of injection with alcohol.

8) Take off the inner protection cover of the needle, insert the needle into the muscle you want to inject and press the start-stop button.

9) When the entire dose is injected, you will see the stopper of the PRL cartridge, not moving, just above the dose regulator.

10) Take the needle out of the muscle and wipe the skin with alcohol.

B. After injection

A. If you want to use again the same cartridge next time.

- Put back in place the inner and outer protection covers of the needle.
- Unscrew the needle from the needle connector and dispose it safely.
- Place ObiPen, the needle connector handler and a new needle, inside the ObiPen case, for future use.

B. If you want to keep ObiPen empty for next time use.

- Put back in place the inner and outer protection covers of the needle.
- Unscrew the needle from the needle connector and dispose it safely.
- Using the needle connector handler, unscrew the needle connector.
- Take out the PRL cartridge, dispose it if it's empty or keep it safely for future use.
- Again using the needle connector handler, screw the needle connector to its original place.
- Bring the dose regulator to its lower position, pressing at the same time, the air release button. Be careful, if you don't press the air release button, you won't be able to bring the dose regulator to its lower position.
- Place ObiPen, the needle connector handler and a new needle, inside the ObiPen case, for future use.

C. Battery replacement

ObiPen uses 2 AA 1.5V batteries, which are enough for, at least, 200 injections. Replace the batteries if you observe that it's taking longer time than usual to make an injection. To do so, remove the battery case replace the old batteries with new ones and close again the battery case.